

STAGE ONE of the Performing Arts Complex of Delaware County, PA

101 Plush Mill Road ♦ Wallingford, PA 19086

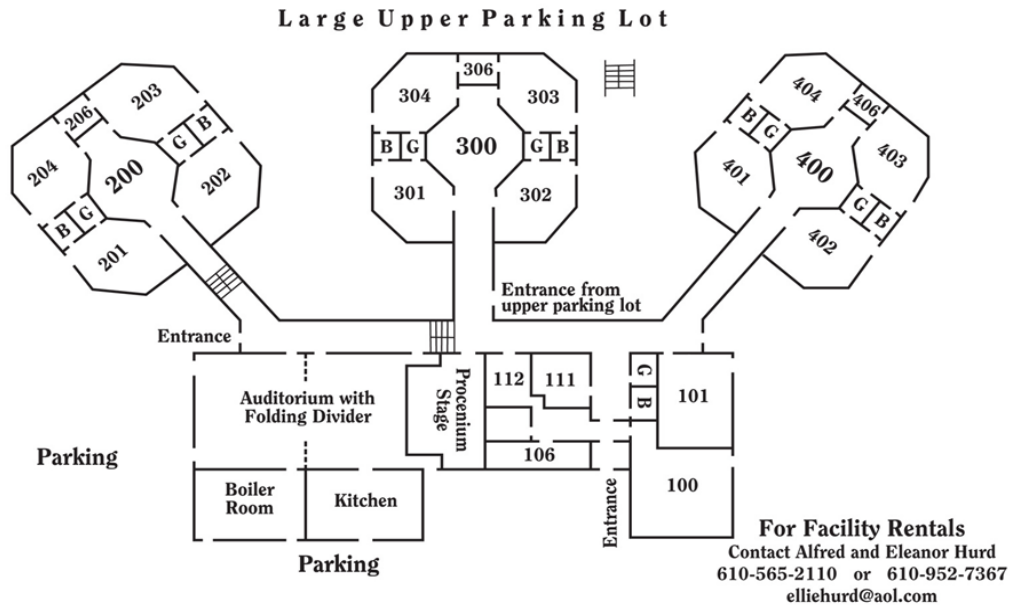

STAGE ONE TIERED RENTS — Daily Rates, Effective March 1, 2015

- Categories:
- 1: Basic Rates for Profit Making Professional Groups (non 501.c.3) such as dance academies, etc.
 - 2: Discounted rates for Nonprofit Amateur Groups.
 - 3: Further discounted rates for Nonprofit Small, Ad-Hoc Groups, often doing new works by an individual working with friends.

TIER CATEGORY	1	1	2	2	3	3
Wkday=Mon,Tue,Wed,Thu — Wkend=Fri,Sat,Sun	Wkday	Wkend	Wkday	Wkend	Wkday	Wkend
Theater for performance/event with 2 dressing rooms	\$300	\$300	\$250	\$250	\$150	\$150
Theater for performance/event with no dressing rooms	\$250	\$250	\$200	\$200	\$125	\$125
Theater for rehearsal with 2 dressing rooms	\$150	\$150	\$110	\$110	\$55	\$55
Theater for rehearsal with no dressing rooms	\$100	\$100	\$65	\$75	\$50	\$50
Large rehearsal rooms (100,101,302,401—404)	\$70	\$85	\$50	\$60	\$45	\$45
Small rehearsal rooms (111,112,301,303,304)	\$55	\$65	\$40	\$50	\$35	\$35
Dance studio room 203 (professional dance floor)	\$80	\$90	\$60	\$70	\$50	\$55
Concession area—room 200 only	\$65	\$75	\$45	\$55	\$30	\$35
Kitchen—includes gas for stove & hot water	\$100	\$125	\$70	\$80	\$60	\$65
Kitchen—without stove or hot water	\$35	\$35	\$35	\$35	\$35	\$35

If admission is charged, there is an additional fee of 5% of the Gate.

Stage Lighting: Fee negotiable with First Stage Lighting who will set & operate lights.
Contact John Adamson: **484-680-3253** or jadamson@usa.com